

INSTALLATION INSTRUCTIONS

DUAL-SAFE Dual Immersion Thermostat

CODE 3235
Q12-015 rev 01

EXPLODED VIEW

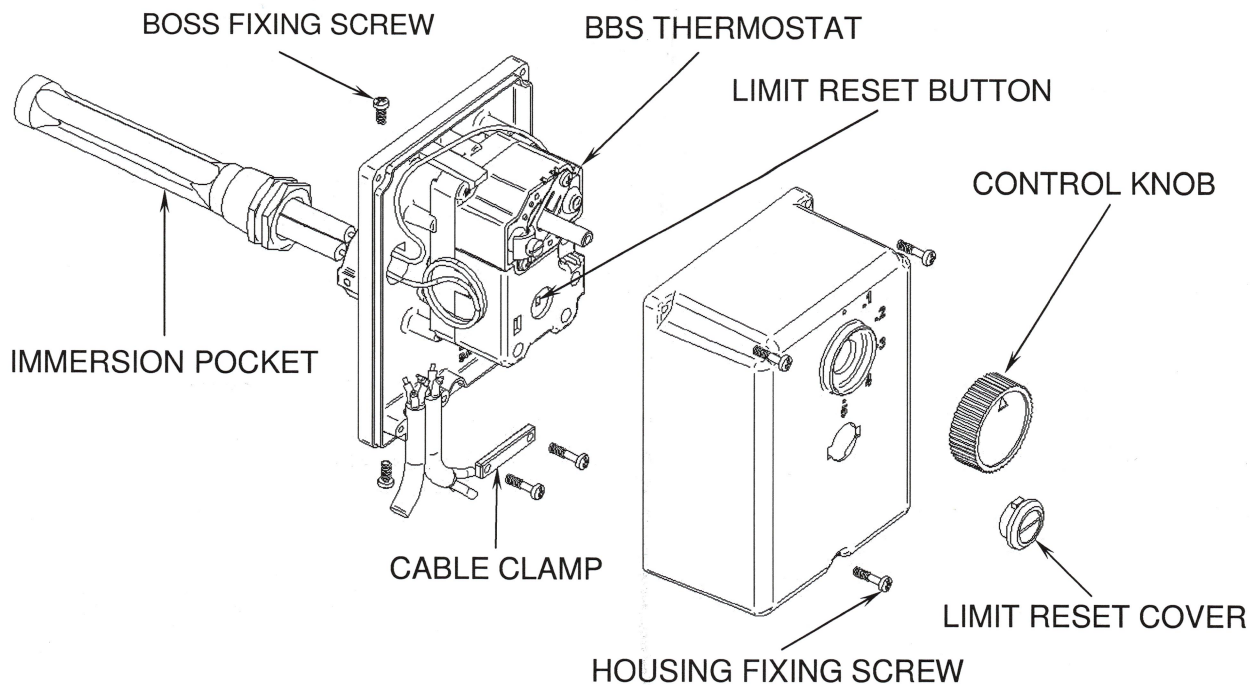

WIRING DIAGRAM

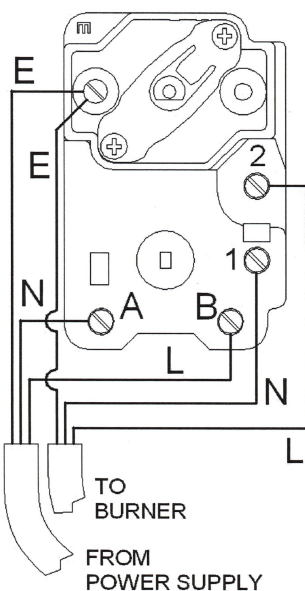

SECURE ALL THE LIVE AND NEUTRAL WIRES TOGETHER WITH CABLE TIES, KEEPING THE CABLE TIES AS CLOSE TO THE LIVE CONNECTIONS, B AND 2, AS POSSIBLE

CONTROLS DIAGRAM

SET CONTROL KNOB TO POSITION 3 ON INSTALLATION
ROTATE CONTROL KNOB CLOCKWISE TO INCREASE TEMPERATURE ONLY IF REQUIRED

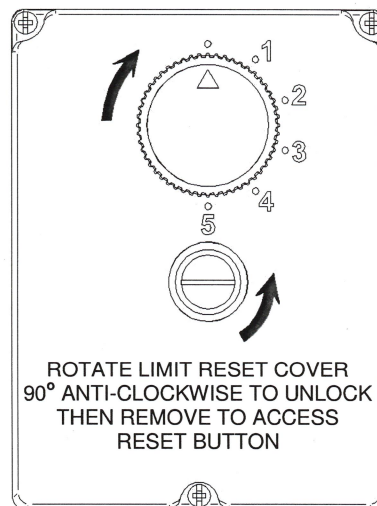

50 – 80°C TEMPERATURE RANGE

BBS THERMOSTAT APPROVALS:
EN60730



RATING: 5A / 230V

DUAL-SAFE APPROVALS:
EN60335-1



INSTALLATION INSTRUCTIONS

DUAL-SAFE Side Pocket Thermostat

CODE 3235
Q12-015 rev 01

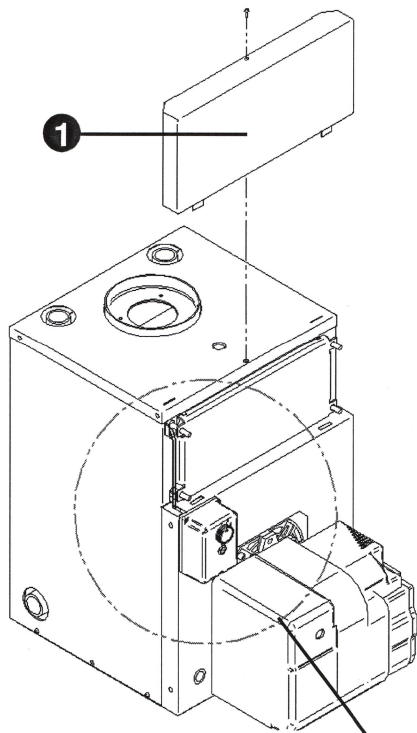

- 1 – REMOVE SERVICE DOOR COVER**
REMOVE RETAINING SCREW THEN LIFT COVER UPWARDS TO ACCESS SERVICE DOOR AND THERMOSTAT POCKET

- 2 – INSERT THERMOSTAT CAPILLARIES**
INSERT CAPILLARIES INTO THERMOSTAT POCKET THEN PUSH IN FULLY, TAKING CARE NOT TO KINK THE STEMS

- 3 – SECURE CAPILLARIES WITH LOCKING TAB**
AFTER INSERTING THERMOSTAT CAPILLARIES, FOLD OVER LOCKING TAB TO SECURE CAPILLARIES

- 4 – MOUNT THERMOSTAT BASE**
USING THE SCREWS SUPPLIED WITH THE THERMOSTAT, SECURE THE THERMOSTAT TO THE BOILER CASING.

- 5 – ASSEMBLE THERMOSTAT HOUSING**
ASSEMBLE THERMOSTAT HOUSING AS SHOWN OVERLEAF

